

Drawing



Tools for Chefs

Hendi B.V.
 Steenoven 21
 3911 TX Rhenen
 The Netherlands

| | |
|---------------|-----------------|
| Batch # | Appliance part# |
| 000000 and up | 233757 |

| |
|-----------------------|
| Description |
| Sushi display 5x1/3GN |

| | | | |
|----------|-------------------------------|------------|-----|
| Date | 25-11-2021 | Revision # | 1.0 |
| Revision | First Bill of Materials (BOM) | | |

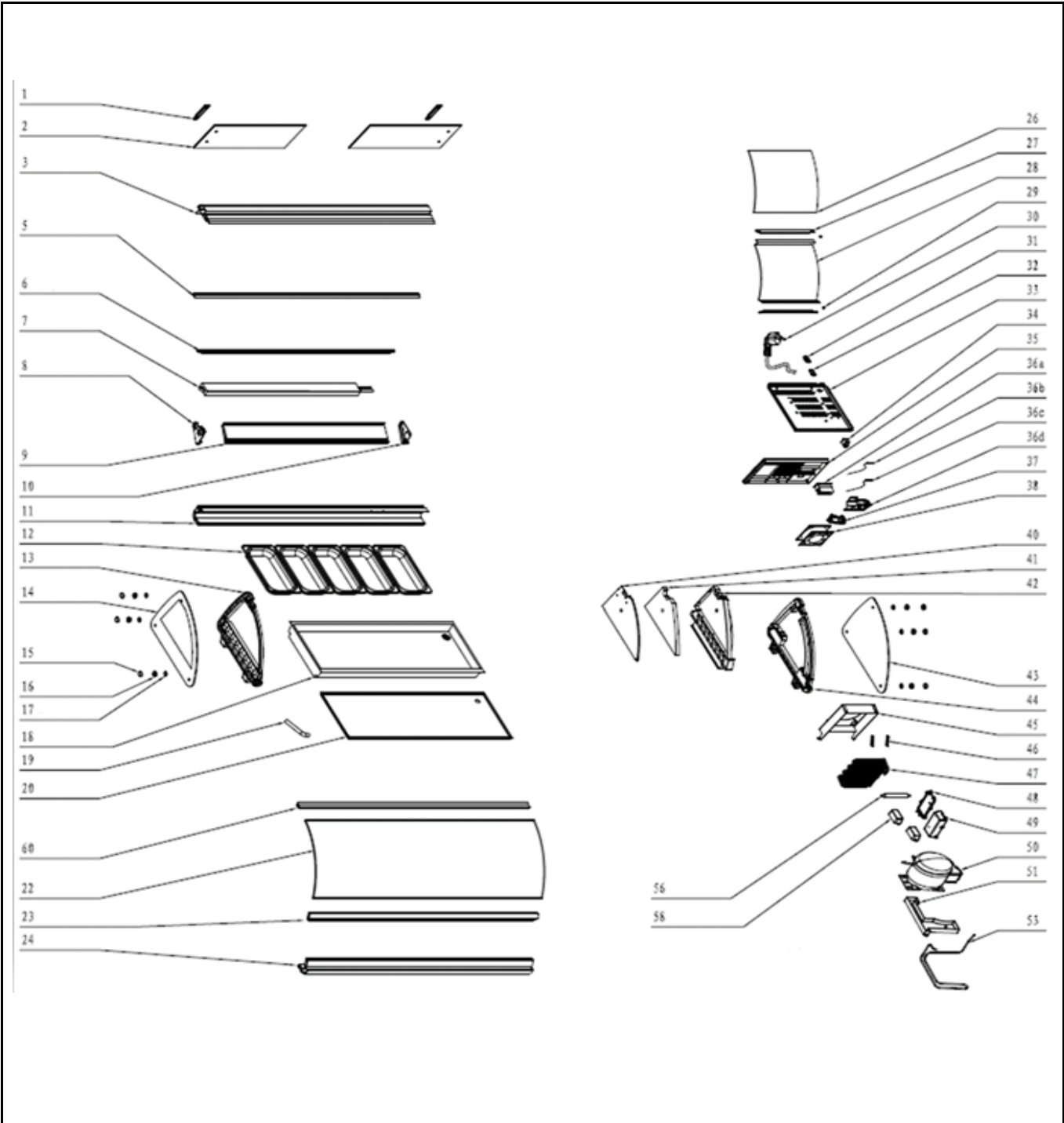

Bill of materials (BOM)

| | | |
|--|------------------------------|------------------------|
|  <b style="font-size: 24px; margin-left: 10px;">HENDI Tools for Chefs Hendi B.V. Steenoven 21 3911 TX Rhenen The Netherlands | Batch # | Appliance part# |
| | 000000 and up | 233757 |
| | Description | |
| | Sushi display 5x1/3GN | |

| | | | |
|-----------------|-------------------------------|-------------------|-----|
| Date | 25-11-2021 | Revision # | 1.0 |
| Revision | First Bill of Materials (BOM) | | |

| Item | Description | Part# | Quantity | Remark | Picture |
|------|-------------------------------|--------|----------|--------------------------|---------|
| 1 | Door handle | n/a | 2 | | |
| 2 | Glass door | n/a | 2 | | |
| 3 | Glass bracket (top) | n/a | 1 | | |
| 5 | Insulation strip | n/a | 1 | | |
| 6 | LED light (chamber) | 961759 | 1 | | |
| 7 | Evaporator | n/a | 1 | | |
| 8 | Water tray bracket (left) | n/a | 1 | | |
| 9 | Cover | n/a | 1 | | |
| 10 | Water tray bracket (right) | n/a | 1 | | |
| 11 | Rear bracket | n/a | 1 | | |
| 13 | Plastic side panel (left) | nss | 1 | | |
| 14 | Glass side panel (left) | 961766 | 1 | | |
| 15 | Decorative cover nut | nss | 6 | | |
| 16 | Gasket nut (small) | nss | 6 | | |
| 17 | Gasket nut (large) | nss | 6 | | |
| A | Glass mount nut | 961773 | 6 | Incl. item 15, 16 and 17 | |
| 18 | Insulation tray | n/a | 1 | | |
| 19 | Drain pipe | n/a | 1 | | |
| 20 | Bottom tray | n/a | 1 | | |
| 22 | Curved glass | 961780 | 1 | | |
| 23 | Cuvrved glass strip | n/a | 1 | | |
| 24 | Curved glass bracket (bottom) | n/a | 1 | | |
| 26 | Cover | n/a | 1 | | |
| 27 | LED light (display) | 961797 | 1 | | |
| 28 | Compressor cover | n/a | 1 | | |
| 29 | Washer | n/a | 2 | | |
| 30 | Power cord | 948743 | 1 | | |
| 31 | Power cord retention A | n/a | 1 | | |
| 32 | Power cord retention B | n/a | 1 | | |
| 33 | Compressor bracket | n/a | 1 | | |
| 34 | Switch | 952498 | 1 | | |
| 35 | Housing cover (rear) | n/a | 1 | | |
| 36a | Display | n/a | 1 | | |
| 36b | Temperature probe | n/a | 1 | | |
| 36c | Defrost probe | n/a | 1 | | |
| 36d | Main PCB | 948729 | 1 | | |
| 38 | Fan motor | 953624 | 1 | | |
| 40 | Bracket cover | n/a | 1 | | |
| 41 | Bracket insulation | n/a | 1 | | |
| 42 | Bracket | n/a | 1 | | |
| 43 | Glass side panel (right) | 961803 | 1 | | |
| 44 | Plastic side panel (right) | n/a | 1 | | |
| 45 | Condenser cover | n/a | 1 | | |
| 47 | Condenser | n/a | 1 | | |
| 48 | Controller housing cover | n/a | 1 | | |
| 49 | Contoller housing | n/a | 1 | | |
| 50 | Compressor | 948828 | 1 | | |
| 51 | Water tray | n/a | 1 | | |
| 53 | Re-evapration tube | n/a | 1 | | |
| 56 | Dryer filter | n/a | 1 | | |
| 58 | LED driver | 952375 | 1 | | |
| 60 | Curved glass bracket (top) | n/a | 1 | | |

n/a -> not available

nss -> not sold separately

Circuit diagram

| | | |
|--|-----------------------|------------------------|
|  HENDI Tools for Chefs Hendi B.V. Steenoven 21 3911 TX Rhenen The Netherlands | Batch # | Appliance part# |
| | 000000 and up | 233757 |
| | Description | |
| | Sushi display 5x1/3GN | |

| | | | |
|-----------------|-------------------------------|-------------------|-----|
| Date | 25-11-2021 | Revision # | 1.0 |
| Revision | First Bill of Materials (BOM) | | |

