

# Ersatzteilliste-Explosionszeichnung

## COOL-LINE-Kühlaufsatz PA 13-180

[Art. 435131802]

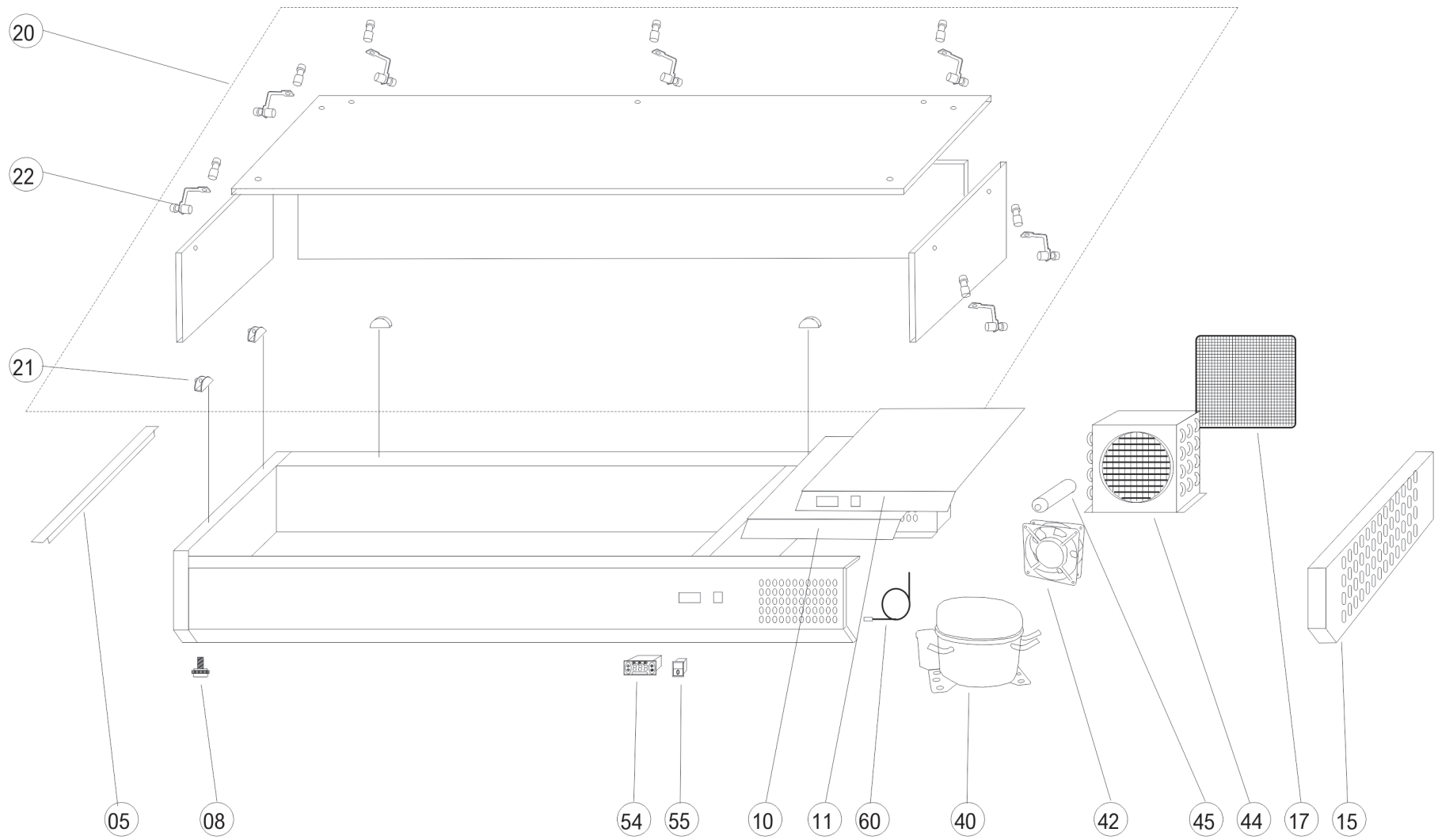



| <b>POS.</b> | <b>REF.NO.</b> | <b>ITEM</b>                    | <b>Unit</b> |
|-------------|----------------|--------------------------------|-------------|
| 00004       | 7120100000     | DIVIDER FOR 1/6 PANS 178x16 MM | STK         |
| 00005       | 7120300001     | DIVIDER FOR 1/3 PANS 326x66 MM | STK         |
| 00008       | 7200000900     | ADJUSTABLE FEET                | STK         |
| 00010       | 7500005011     | UNIT ROOM COVER FOR COMPRESSOR | STK         |
| 00011       | 7500005035     | UNIT ROOM COVER FOR THERMOSTAT | STK         |
| 00015       | 7500005015     | UNIT SIDE                      | STK         |
| 00017       | 7500002204     | FILTER 160X200                 | STK         |
| 00020       | 7500005007     | COMPLETE VK GLASS WITH FIXING  | STK         |
| 00021       | 7200000907     | CLIPS GLASS COVER              | STK         |
| 00022       | 7500002203     | GLASS NUT/BOLT/CLIPS COMPLETE  | STK         |
| 00040       | 7500005033     | COMPRESSOR HDL100A R600a       | STK         |
| 00042       | 7200000305     | COND./EVAP. FAN RAH1238B       | STK         |
| 00044       | 7500002201     | CONDENSOR                      | STK         |
| 00045       | 7200002136     | FILTER DRIER 20 G              | STK         |
| 00054       | 7110000391     | THERMOSTAT XR02CX, 20 A RELAY  | STK         |
| 00055       | 7110002401     | MAIN SWITCH                    | STK         |
| 00060       | 7110000397     | PROBE NTC DIXELL/CAREL 10 Kohm | STK         |