

Ersatzteilliste-Explosionszeichnung

COOL-LINE-Kühlaufsatz PA 14-200

[Art. 435142002]

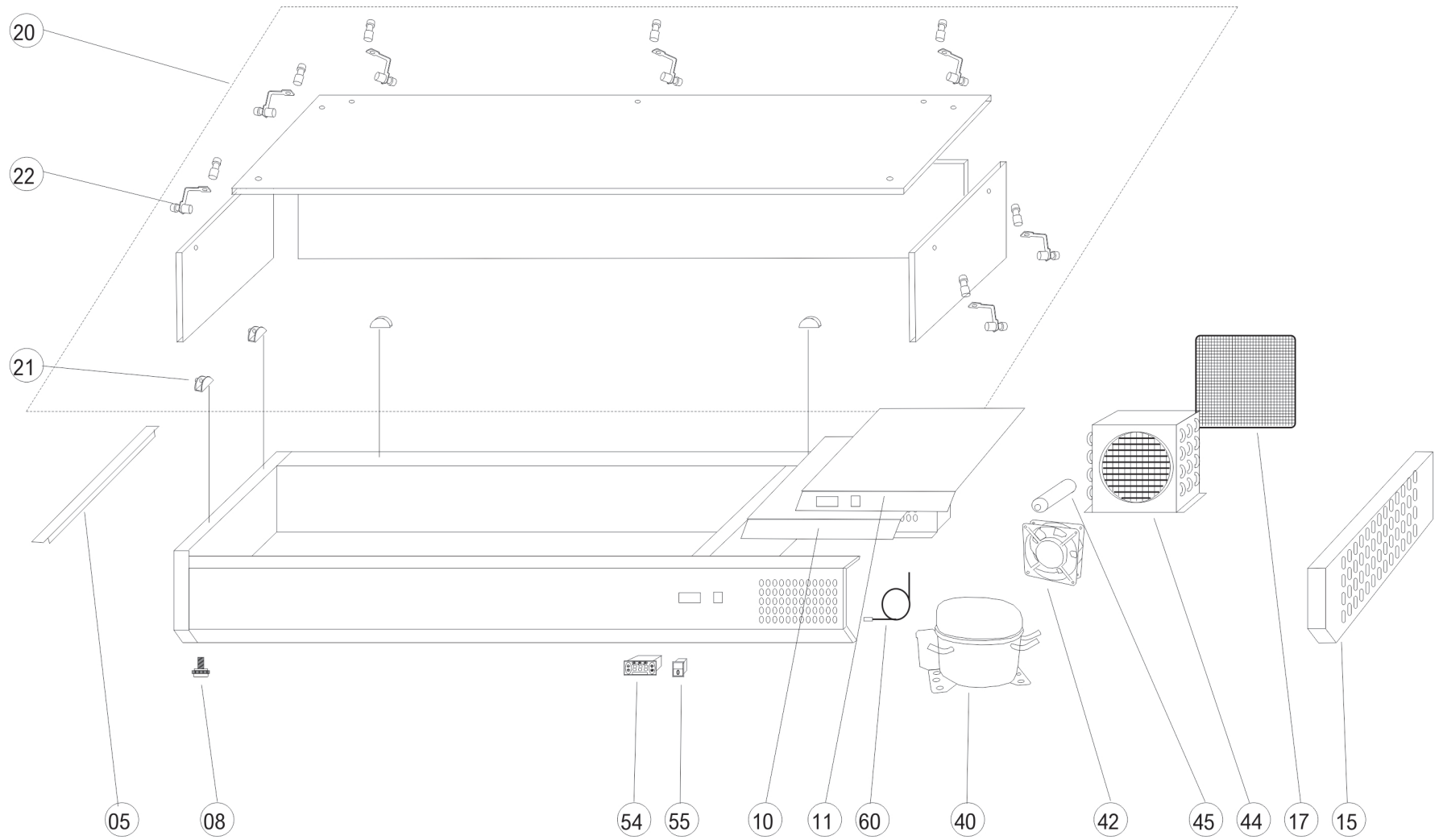



| POS. | REF.NO. | ITEM | Unit |
|-------------|----------------|--------------------------------|-------------|
| 00008 | 7200000900 | ADJUSTABLE FEET | STK |
| 00010 | 7500005012 | UNIT ROOM COVER FOR COMPRESSOR | STK |
| 00011 | 7500005034 | UNIT ROOM COVER FOR THERMOSTAT | STK |
| 00015 | 7500005014 | UNIT SIDE | STK |
| 00017 | 7500002204 | FILTER 160X200 | STK |
| 00020 | 7500005001 | COMPLETE VK GLASS WITH FIXING | STK |
| 00021 | 7200000907 | CLIPS GLASS COVER | STK |
| 00022 | 7500002203 | GLASS NUT/BOLT/CLIPS COMPLETE | STK |
| 00040 | 7500005033 | COMPRESSOR HDL100A R600a | STK |
| 00042 | 7200000305 | COND./EVAP. FAN RAH1238B | STK |
| 00044 | 7500002201 | CONDENSOR | STK |
| 00045 | 7200002136 | FILTER DRIER 20 G | STK |
| 00054 | 7110000391 | THERMOSTAT XR02CX, 20 A RELAY | STK |
| 00055 | 7110002401 | MAIN SWITCH | STK |
| 00060 | 7110000397 | PROBE NTC DIXELL/CAREL 10 Kohm | STK |