

Ersatzteilliste-Explosionszeichnung

Energiespar-Tiefkühltruhe Serie **EL XLE**

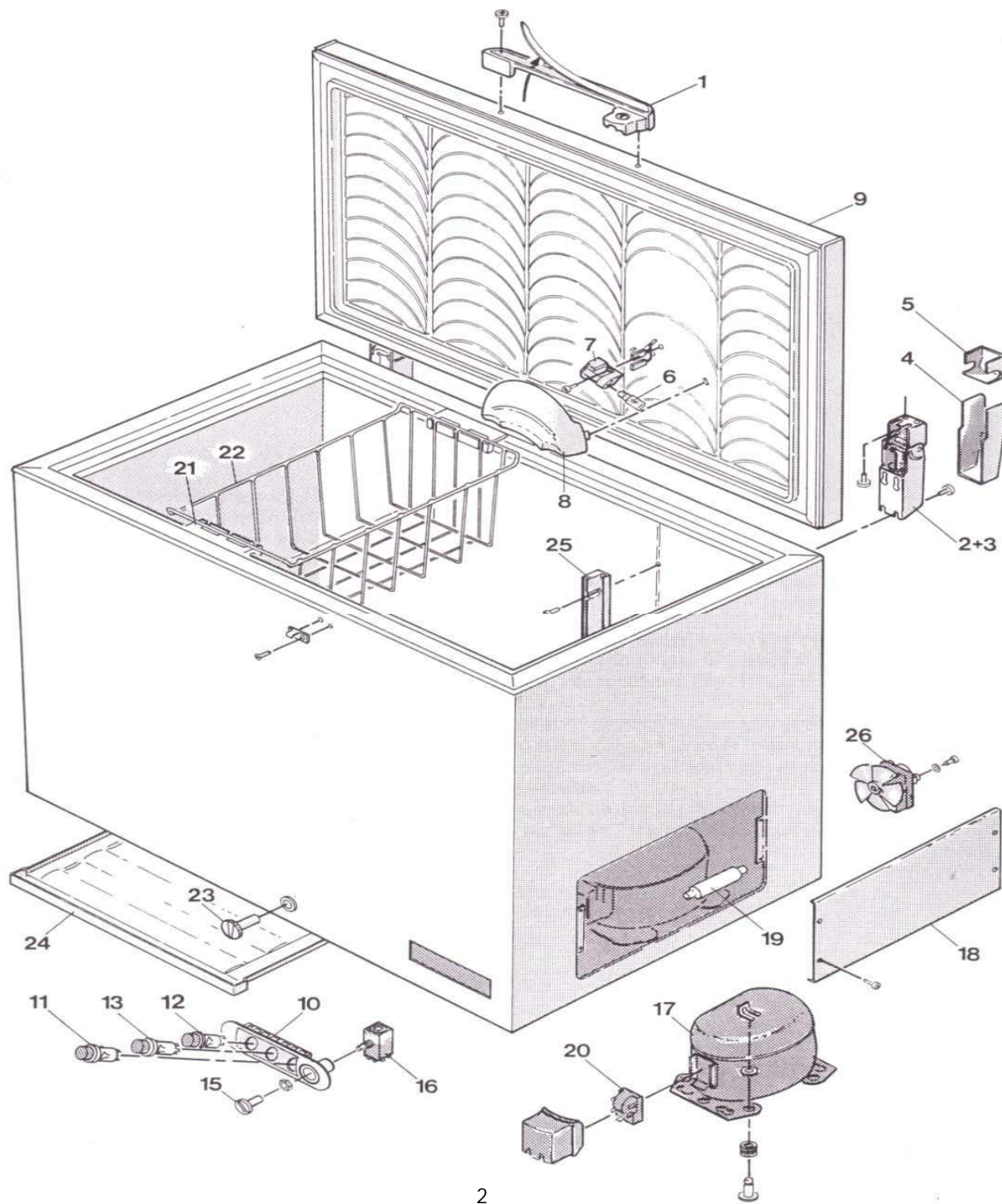



ITEM NO.	DESCRIPTION	11 XLE		21 XLE		31 XLE		41 XLE		51 XLE	
		CODE		CODE		CODE		CODE		CODE	

SOLID LIFTING LID

1	HANDLE EL W/LOCK	EPCH		EPCH		EPCH		EPCH		EPCH	
2	HINGE 0.0	---		---		HAENG00		---		HAENG00	
3	HINGE 42	2XHAENG42		---		---		---		---	
3	HINGE 4.6	----		2XHAENG46		2XHAENG46		----		----	
3	HINGE 4.9	----		---		---		2XHAENG49		2XHAENG49	
4	HINGE COVER LARGE	HAENGKAPHV-L		HAENGKAPHV-L		HAENGKAPHV-L		HAENGKAPHV-L		HAENGKAPHV-L	
5	HINGE COVER SMALL	HAENGKAPHV-S		HAENGKAPHV-S		HAENGKAPHV-S		HAENGKAPHV-S		HAENGKAPHV-S	
6	E 14 BULP	E14220		E14220		E14220		E14220		E14220	
7	LIGHT SOCKET	FATNING		FATNING		FATNING		FATNING		FATNING	
8	COVER F/LID LIGHT	E15H		E15H		E15H		E15H		E15H	
9	LID COMPLETE	8010.0105		8010.0205		8010.0303		8010.0404		8010.0500	

MOTOR COMPARTMENT

17	COMPRESSOR 230V/50Hz R600A	NLX8.8KK		NLX8.0KK2		NLX8.0KK2		NLX10KK2		NLX13KK.1	
19	DRYING FILTER	FILTER6XH9		FILTER6XH9		FILTER6XH9		FILTER6XH9		FILTER6XH9	
20	PTC STARTRELA	103N0016		103N0016		103N0016		103N0016		103N0016	

CONTROL PANEL

10	ANGLED PANEL XLE	E13H		E13H		E13H		E13H		E13H	
11	LAMP RED ROUND	LAMPROD		LAMPROD		LAMPROD		LAMPROD		LAMPROD	
12	LAMP GREEN ROUND	LAMPGRO		LAMPGRO		LAMPGRO		LAMPGRO		LAMPGRO	
13	LAMP YELLOW ROUND	LAMPGUL		LAMPGUL		LAMPGUL		LAMPGUL		LAMPGUL	
15	TERMOSTATE BUTTON	77.316		77.316		77.316		77.316		77.316	
16	TERMOSTATE XLE	TERMOSTAT15		TERMOSTAT15		TERMOSTAT15		TERMOSTAT15		TERMOSTAT15	

OTHER

18	GRILL F/ENGINE ROOM	SP1417		SP1417		SP1417		SP1417		SP1417	
21	HANDLE F/BASKET	E71H		E71H		E71H		E71H		E71H	
22	BASKET	KURVSLEH		KURVSLEH		KURVSLEH		KURVSLEH		KURVSLEH	
23	STOPPER FOR OUTSIDE DRAIN	E1HU		E1HU		E1HU		E1HU		E1HU	
24	PARTITION	SKILLERUM2		SKILLERUM2		SKILLERUM2		SKILLERUM2		SKILLERUM2	
25	MOULDING F/PARTITION	STYRLIST2		STYRLIST2		STYRLIST2		STYRLIST2		STYRLIST2	
	FOOT COMPLETE	SP1412+SP1413		SP1412+SP1413		SP1412+SP1413		SP1412+SP1413		SP1412+SP1413	

NordCap GmbH & Co. KG
Thalenhorststraße 15
28307 Bremen
Hauptsitz (Service, Finanzen & Personal, Lager, IT, Marketing)

Telefon: +49 421 48557-0
Telefax: +49 421 488650
E-Mail: bremen@nordcap.de

Die NordCap Verkaufsniederlassungen in Deutschland:

Nord: Hamburg • Ost: Berlin • Süd: Ingelheim • West: Erkrath

